

All new Yutaki have the same terminal board.

One of HITACHI exclusivity on this new range is Sensors, Inputs / Outputs configurable function: **All types of installations are possible with a Yutaki!**

YUTAKI 2016 Terminal Board

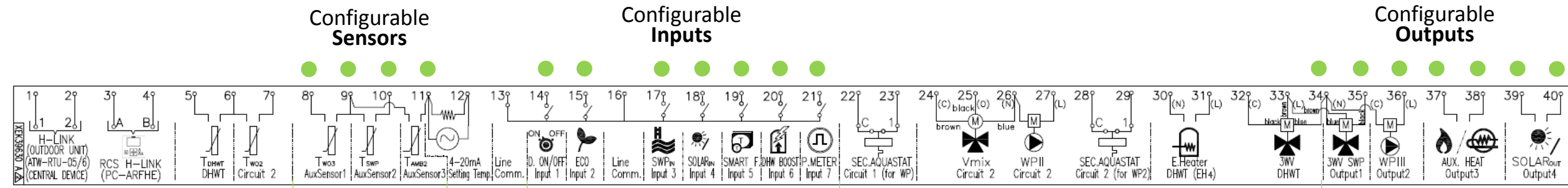

4 SENSORS
7 configurations possible

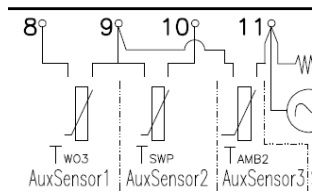

7 INPUTS
17 configurations possible

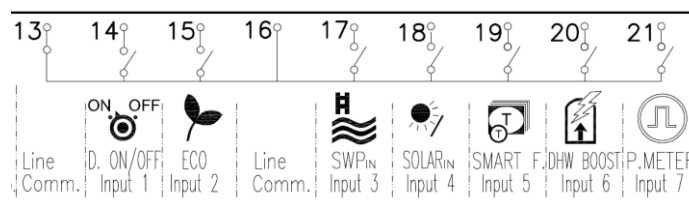

8 OUTPUTS
15 configurations possible

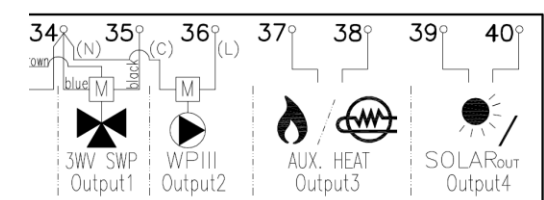

4 Outputs available on Terminal Board
+ 4 outputs available through Auxiliary output signal box ATW-AOS-02

I/O & Sensors configuration



YUTAKI 2016 Unit controller (PC-ARFHE) → How to define new Sensors, Inputs & Outputs

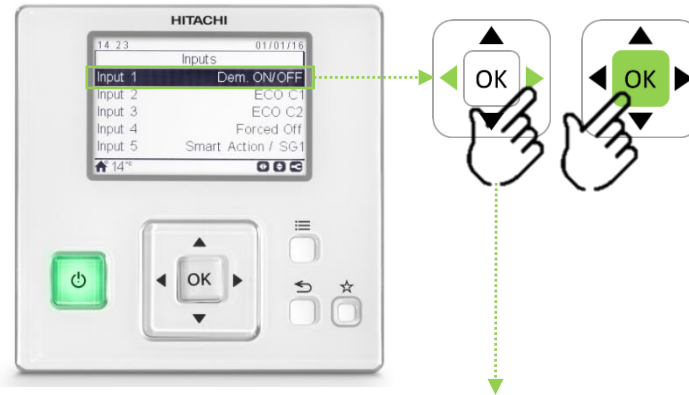
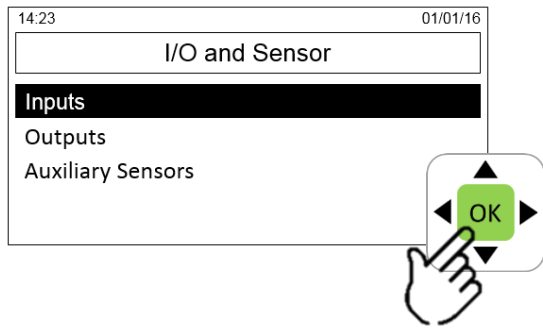

4 SENSORS - 7 configurations possible

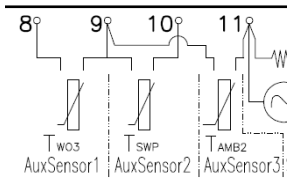

7 INPUTS - 17 configurations possible

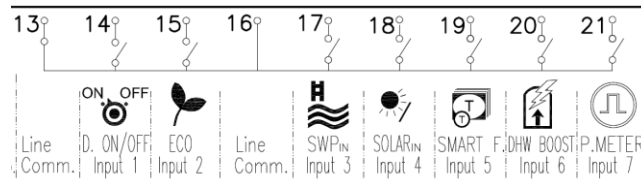

8 OUTPUTS - 15 configurations possible

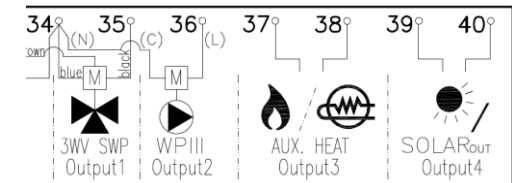

SENSORS - LIST OF AVAILABLE FUNCTIONS

1	Two3
2	Swimming pool
3	Solar panels sensor
4	C1 & C2 Ambient
5	C1 Ambient
6	C2 Ambient
7	Outdoor Sensor

INPUTS - LIST OF AVAILABLE FUNCTIONS

1	Demand ON/OFF	10	Forced heating
2	Smart Action / SG1	11	Forced cooling
3	Swimming pool	12	Power Meter 2
4	Solar	13	Eco Mode C1&C2
5	Operation mode	14	Eco Mode C1
6	DHW Boost	15	Eco Mode C2
7	Power Meter 1	16	Force OFF
8	Demand ON/OFF C1	17	Smart Grid Ready (SG2)
9	Demand ON/OFF C2		

OUTPUTS - LIST OF AVAILABLE FUNCTIONS

1	3WV Swimming Pool	9	Heating signal
2	Water pump 3	10	DHW signal
3	Boiler combination	11	Solar 3WV
4	Solar pump	12	Defrost
5	Alarm signal	13	DHW Re-circulation pump
6	Operation signal	14	Heater combination (S80/M) Relay 1
7	Cooling signal	15	Heater combination (S80/M) Relay 2
8	Demand ON signal C1		

These ranges of functions are available only if they have been activated onto PC-ARFHE. (Example: Swimming pool is available only if it has been declared on the unit.)